

## BS Collar Eyebolts STD Shank (Metric)

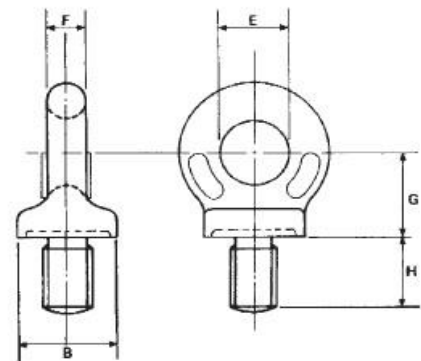

- \* **Material:** As Specified by BS 4278  
Hardened & Tempered
- \* **WLL:** shown at 0° (Vertical) angle of lift
- \* **Specification:** BS 4278: Table 1 1984
- \* **Certificates:** Supplied with relevant certificates.



WLL Tonnes	Thread Size	B (mm)	E (mm)	F (mm)	G (mm)	H (mm)	Weight Each (Kgs)
0.15	M8	22	15	9	20	18	0.06
0.25	M10	22	15	9	20	18	0.06
0.4	M12	22	15	9	20	18	0.07
0.8	M16	29	20	12	26	23	0.16
1.6	M20	40	27	16	36	32	0.44
1.6	M22	52	35	21	46	40	0.80
2.5	M24	52	35	21	46	40	0.85
4	M30	65	44	26	58	51	1.66
6.3	M36	81	54	32	72	63	3.17
10	M48	101	68	40	90	79	9
12.5	M52	115	76	46	102	89	9
16	M56	128	86	51	114	100	13
20	M64	144	96	58	128	112	17.5
25	M72	162	108	65	144	126	31

**SAFETY NOTE: EYEBOLTS UNDER M12 ARE NOT RECOMMENDED FOR LIFTING**