

## British Standard Self Colour Large Bow Shackle

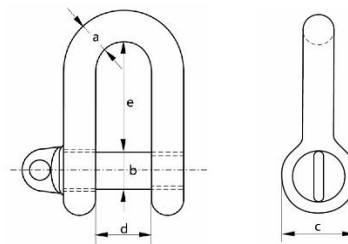

- \* **Material:** Body and pin High tensile Steel
- \* **Safety Factor:** MBL equals 5 x WLL
- \* **Standard:** Generally to BS3032 table 2 - 1958
- \* **Finish:** Self Colour
- \* **Certificates:** Supplied with relevent certificates



Working Load Limit	Diameter Bow	Diameter Pin	Diameter Eye	Inside Width	Inside Length	Weight Each
tons	a inch	b inch	c inch	d inch	e inch	kg
0.30	1/4	3/8	3/4	3/8	7/8	0.06
0.60	3/8	1/2	1	5/8	1.3/8	0.15
1.00	1/2	5/8	1.1/4	7/8	1.7/8	0.33
1.75	5/8	3/4	1.1/2	1	2.1/4	0.61
2.50	3/4	7/8	1.3/4	1.1/4	2.3/4	0.93
3.50	7/8	1	2	1.3/8	3.1/4	1.50
4.50	1	1.1/8	2.1/4	1.1/2	3.5/8	2.15
5.50	1.1/8	1.1/4	2.1/2	1.3/4	4.1/8	3.02
7.00	1.1/4	1.3/8	2.3/4	1.7/8	4.1/2	4.20
8.00	1.3/8	1.1/2	3	2.1/8	5	5.34
10.75	1.1/2	1.3/4	3.1/2	2.3/8	5.1/2	8.36
13.00	1.5/8	1.7/8	3.3/4	2.1/2	5.7/8	9.35
14.75	1.3/4	2	4	2.3/4	6.3/8	12.39
16.75	1.7/8	2.1/8	4.1/4	2.7/8	6.3/4	15.30
19.00	2	2.1/4	4.1/2	3	7.1/4	18.40